



February 17, 2025

PROJECT NAME: PHS - STADIUM PARKING LOT REPLACEMENT

DISTRICT: PITTSBURG UNIFIED SCHOOL DISTRICT

DSA APPLICATION NO: 01-122520

ADDENDUM #1

This Addendum forms part of the Contract Documents and modifies the Original Bidding Documents and previous Addenda as noted below. Acknowledge receipt of this Addendum in the space provided in the Bid Form. Failure to do so may subject Bidder to disqualification.

GENERAL:

ITEM NO. 1.1. SIGN IN SHEET

ITEM NO. 1.2 PRE BID CONFERENCE AND WALK THRU

ITEM NO. 1.3 SHEET A102 ENLARGED SITE PLAN
a) Added detail reference 5/A2.03 to keynote "102"
b) Edited keynote "103"
c) Edited keynote "110".
d) Edited keynote on site plan "102" to include pedestrian gate.

ITEM NO. 1.4 SHEET A203 PROPOSED FENCING GATE ELEVATIONS
a) Added entry gate elevation #5

ITEM NO. 1.5

SHEET A502 DETAILS

- a) Revised detail #3 to remove arrow picket heads to flat.
- b) Edited detail #7 height callout.

ATTACHMENTS:

- 1. SIGN IN SHEET
- 2. PRE-BID CONF AND WALKTHROUGH
- 3. PLAN SHEETS: A102, A203, A502

END OF ADDENDUM NO. 1

Thank you and please call or email with any further questions.

Rodolfo Chacon, Architect
559-240-0288 cell



Pre-Bid Conference & Walkthrough Sign-In Sheet

Date: Wednesday, 02/11/2026 @ 3:30 PM (PST) at Pittsburgh HS, 1750 Harbor Street, Pittsburgh, CA

Pittsburg HS – Stadium Parking Lot Replacement Project

Print Name	Signature	Company Name	Email Address	Phone #
MIKE BARROS		PUSD	mbarros@PITTSBURGH.NET	925-963-4884
Lance L. Cisse		PUSD	lancecisse@cloud.com	925-2876225
Jorge Sauter		Bosco Court	estimating@bosco.com	609-3281504
JOE DWYER		Pacific Power & Systems	JOED@PACIFICPOWERSYSTEM.COM	707-580-0375
ED PEREZ		The KHA GROUP	NORTH estimating@theKHAgroup.com	916-870-8507
Jody Mahinay		CWS Construction	charliejr@cwconstructiongroup.com	415-209-0229
ALAN DALMASO		DRYCO	aland@dryco.com	510-719-6573
FERNANDO FLORES		APENA Engineering	info@apenaengineering.com	(510)343-1299
Jared Baugh		Pacific Coast Gen Eng	Jared@PCGE.biz	925-766-2850
Derrick Lozano		Pacific Coast General Engineering	Derrick@PCGE.biz	925-259-0214
Luis Lin-Flores		McGuire and Hester	estimating@mcguireandhester.com	510-632-7446
JOSE LUIS MANTO		Valley Construction Services, Inc.	estimating@vcsi.com	408-839-8031
JASON MARTIN		OC JONES & SONS	jmartin@ocjones.com	510-809-3432
HECTOR BARAJAS		KEREX ENGINEERING	hector@kerexengineering.com	925-457-7165
Matt Codipilly		RAM Paving	Matt@randmpaving.com	408 724-0523
Juan Delgado-Ho		JOBCO Paving	Juan@jobcopaving.com	408-551-9474



Print Name	Signature	Company Name	Email Address	Phone #
Bernie Ort	[Signature]	Bno Builders	Bids@bnobuilders.com	969-7879130
Isaac Nathaniel	[Signature]	Isaac Nathaniel Paving	Inathaniel64@gmail.com	925-325-7834
Jasmine Towne	[Signature]	Txi - Valley Excavating	Ftwest@tnvalleyx.com	925-305-5379
Andrea Fajardo	[Signature]	Saboo Inc.	office@sabooinc.com	925-260-2849
Costas Legousis	[Signature]	Pull Steam Ahead	allcheerdyn.n.plumbing@gmail.com	925-500-3453
Carlos Jimenez	[Signature]	Frontline General Engineering	Estimating@frontlinengr.com	(709) 673-7670
HARMER XEROX	[Signature]	S & H Const. Inc.	shcalifornia@yahoo.com	510-579-7382
Kati Mejia	[Signature]	PUSD	kmejia@pittsburgusd.net	925-473-2368
Donna Kentanes	[Signature]	PUSD	d.kentanes@pittsburgusd.net	925-473-2448
Cystal Cornelison	[Signature]	Consolidated Engineering	johne@conevig inc.net	925-752-5346
Joe Cornelia	[Signature]	Joe's Lnw. & Conc.	Joe@Joelslo.com	209-597-2185
Keith Holtlander	[Signature]	PUSD	Kholtslander@pittsburgusd.net	925-473-2428
Sean Vandermerney	[Signature]	PUSD	svandermerney@pittsburgusd.net	925-473-2438
Rodolfo Chacon	[Signature]	Chacon Architecture		



Pre-Bid Conference & Walkthrough

Wednesday, 02/11/2026 @ 3:30 PM (PST)

Pittsburg High School, 1750 Harbor Street, Pittsburg, CA

Pittsburg HS – Stadium Parking Lot Replacement Project

CONFERENCE AGENDA –

I. Introduction of Project Team Members:

Sean Vandermeay – PUSD Director of Facilities Management
Keith Holtslander – PUSD Project Manager
Donna Fentanes – PUSD Facilities Specialist
Kati Mejia – PUSD Special Projects Accountant
Matthew Belasco – PUSD Director of MO&T Dept.
Mike Barros – PUSD Supervisor of M&O Dept.
Benjamin Trotter – PUSD Supervisor of M&O Dept.
Louie LaCasse – PHS Groundskeeper
Rodolfo Chacon – Chacon Architecture
TBD – PUSD Project Inspector
TBD – Geotechnical Observations & Materials Testing Contact

II. Schedule:

- A. Friday, February 20, 2026: Pre-Bid RFI's due by 5:00 PM (PST). Pre-Bid RFI's are to be submitted in writing to Rodolfo Chacon at rodolfo@chaconarchitecture.com, with a copy to Keith Holtslander at kholtlander@pittsburgusd.net.
- B. **Thursday, February 26, 2026 @ 2:00 PM (PST): Bids Due**
- C. March 12, 2026: Notice of Award
- D. March 23, 2026: Notice to Proceed
- E. March 23, 2026: On-Site Construction Work Start
- F. July 17, 2026: On-Site Construction Work Completion
- G. August 21, 2026: Contract Completion

III. Requirements of the Bid:

- A. Preparation of Bid Forms – Complete all bid forms; the bids must be signed in the name of the bidder, and submitted in a sealed envelope bearing the name of the bidder and the name of the Project.
- B. Bid Security – Each bid shall be accompanied by a Bid Bond, or a Certified Check or Cashier's Check made payable to the District as described in the Contract Documents.
- C. Designated Subcontractors List, Site Visit Certification and Non-Collusion Declaration are required to accompany Bid.
- D. Delivery of Bids – **2:00 PM (PST) on Thursday, February 26, 2026**. Bids will be received at the **District Site Support Services Center, 3200 Loveridge Road, Pittsburg, CA 94565.**
- E. Insurance Requirements – See General Conditions 00 72 13 Article 13 for Insurance and Bonds, and Special Conditions, 00 73 13, Article 6 for Insurance Policy Limits.

- F. Fingerprinting Requirements – See Special Conditions, Article 9 for the specifics.
- G. Note that the District's PSA with the Local Trades Council will be applicable to this Project if the bid dollar amount total is \$1M or higher.

IV. Site Walk:

- A. Area of Work and Site Access

V. Questions and Answers:

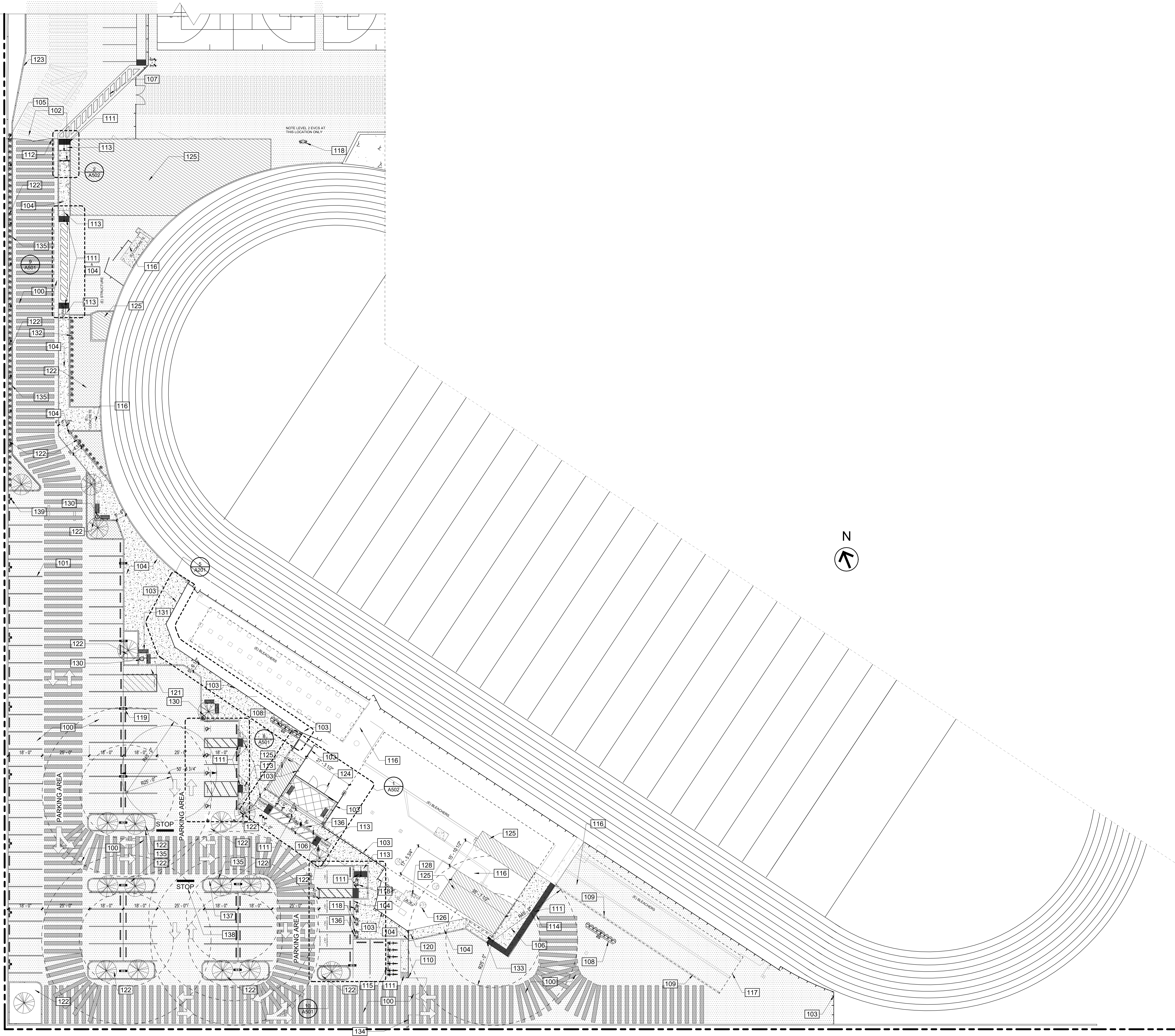

1 ENLARGED SITE PLAN
1" = 20'-0"

LEGEND

- (E) BUILDINGS
- (N) PLANTER AREAS
- (N) ASPHALT CONC. PAVING
- (N) CONC. PAVING
- (N) TREES
- (N) WHEELSTOP
- (E) 20' FIRE LANE
- (E) CHAINLINK FENCING
- (N) 20' FIRE LANE
- INDICATES (N) FIRE TRUCK TURNING RADIUS

KEY NOTES

- 100 (N) ASPHALT PAVING SEE CIVIL DRAWINGS AND SPECIFICATIONS
- 101 (N) MARKINGS
- 102 (N) VEHICULAR & PEDESTRIAN ENTRY GATES. SEE 5/A2.03
- 103 (N) **PVC COATED FABRIC BLACK** OR EQUAL. EXISTING POSTS TO REMAIN. POSTS TO BE CLEANED OF RUST PRIMER, AND PAINTED BLACK OLD BARBED WIRE SUPPORTS @ EXISTING POSTS TO BE REMOVED AND NEW CAP TO BE INSTALLED @ THESE POSTS WHERE NEEDED. SUBMIT VINYL COATING FENCE SAMPLE ARCHITECT AND DISTRICT TO BE PROVIDED CONTACT "CALIFORNIA FENCING" AT 925-872-6551
- 104 (N) 6" RAISED CONCRETE SIDEWALK AND CURB SEE CIVIL PLANS FOR GRADING 5% MAX. SLOPE MAX
- 105 (N) FENCING
- 106 (N) CONCRETE PAVING LEVEL W/ AC PAVING SEE CIVIL PLANS FOR GRADING
- 107 (N) PAINTED CROSSWALK. SEE DETAIL 9/A501 SIM.
- 108 (E) STADIUM LIGHT POLE TO REMAIN
- 109 (E) ASPHALT TERMINATION AT (E) CONCRETE MOW STRIP
- 110 (N) FENCING AND GATES (TRAFFIC) TO BE **BLACK VINYL** COATED BY "CALIFORNIA FENCING" OR EQUAL 925-872-6551 HEIGHT TO MATCH EXISTING/ADJ. FENCING BEING ABUTTED
- 111 (N) DETECTABLE WARNINGS SEE DETAIL 3/A-501
- 112 (N) INDICATES TERMINATION LINE OF NEW ASPHALT PAVING
- 113 (N) CURB RAMP DOWN SEE CIVIL PLANS FOR GRADING 5% MAX. SLOPE MAX
- 114 INDICATES FLUSH TRANSITION TO AC PAVING FROM CONCRETE (45" X 12")
- 115 (N) BICYCLE PARKING SEE LANDSCAPE SHEETS L1.0 & L1.1
- 116 (E) CONCRETE TO REMAIN
- 117 (N) TERMINATION OF NEW AC WIRED WOOD HEADER
- 118 (N) BUS EV CHARGING STATION SEE ELECTRICAL PLANS
- 119 (N) POLE MOUNTED DUAL HEAD LIGHT SEE ELECTRICAL PLANS
- 120 (N) FENCE AND PEDESTRIAN GATE SEE DETAIL 7/A502
- 121 (N) MOTORCYCLE PARKING
- 122 (N) PLANTING AREA SEE LANDSCAPE PLAN SHEET L1.0
- 123 (N) 6" CONCRETE CURB
- 124 (N) STREET PICKET FENCE AND PEDESTRIAN GATE
- 125 (E) STRUCTURE TO REMAIN
- 126 (E) I BEAM COLUMN SUPPORT (TYP) TO REMAIN
- 127 (E) ELECTRICAL BOX TO REMAIN
- 128 (E) TRANSFORMER TO REMAIN
- 129 (E) BOLLARDS (TYP)
- 130 (N) TRASH CAN (TYP.) SEE LANDSCAPE SHEETS L1.0 & L1.1
- 131 (N) BENCH (TYP.) SEE LANDSCAPE SHEETS L1.0 & L1.1
- 132 (N) LIGHTING BOLLARDS SEE ELECTRICAL PLANS
- 133 (N) SLOPED WALK 5% MAX. SLOPE 2% MAX CROSS SLOPE
- 134 (N) KNOX BOXES
- 135 (N) PAINTED CURBS RD STENCIL IN WHITE "NO PARKING - FIRE LANE" SEE DETAIL 8/A5.02
- 136 (N) REMOVABLE BOLLARDS @ 4'-0" O.C. SEE CIVIL
- 137 (N) STOP SIGN SEE CIVIL
- 138 (N) VEHICULAR MARKINGS SEE CIVIL DWGS
- 139 (N) WALL MOUNTED LIGHTS SEE ELECTRICAL DWGS



RODOLFO L. CHACON
EMAIL: rodolfo@chaconarchitecture.com
PHONE: 925-504-8098
ADDRESS: 2106 BOLERO,
BAY POINT, CA. 94565
WWW.CHACONARCHITECTURE.COM

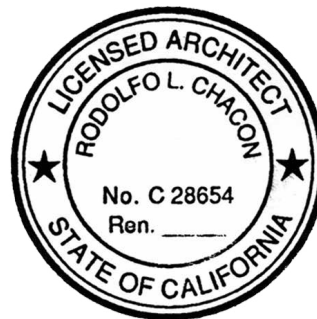

STADIUM PARKING LOT REPLACEMENT PROJECT

1750 HARBOR STREET
PITTSBURG, CA



Pittsburg Unified School
District 2000 Railroad Ave.
Pittsburg, CA 94565

XX 01/07/2025

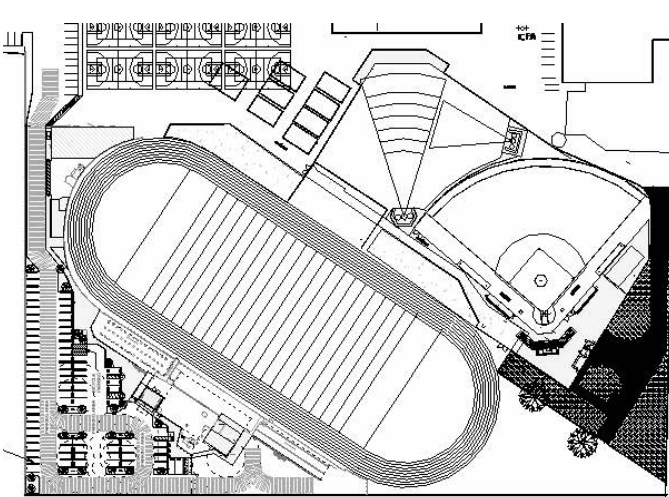

PROJECT NO: PROJECT NUMBER
SUBMITTAL DATE:

SHEET TITLE

ENLARGED SITE
PLAN

A102

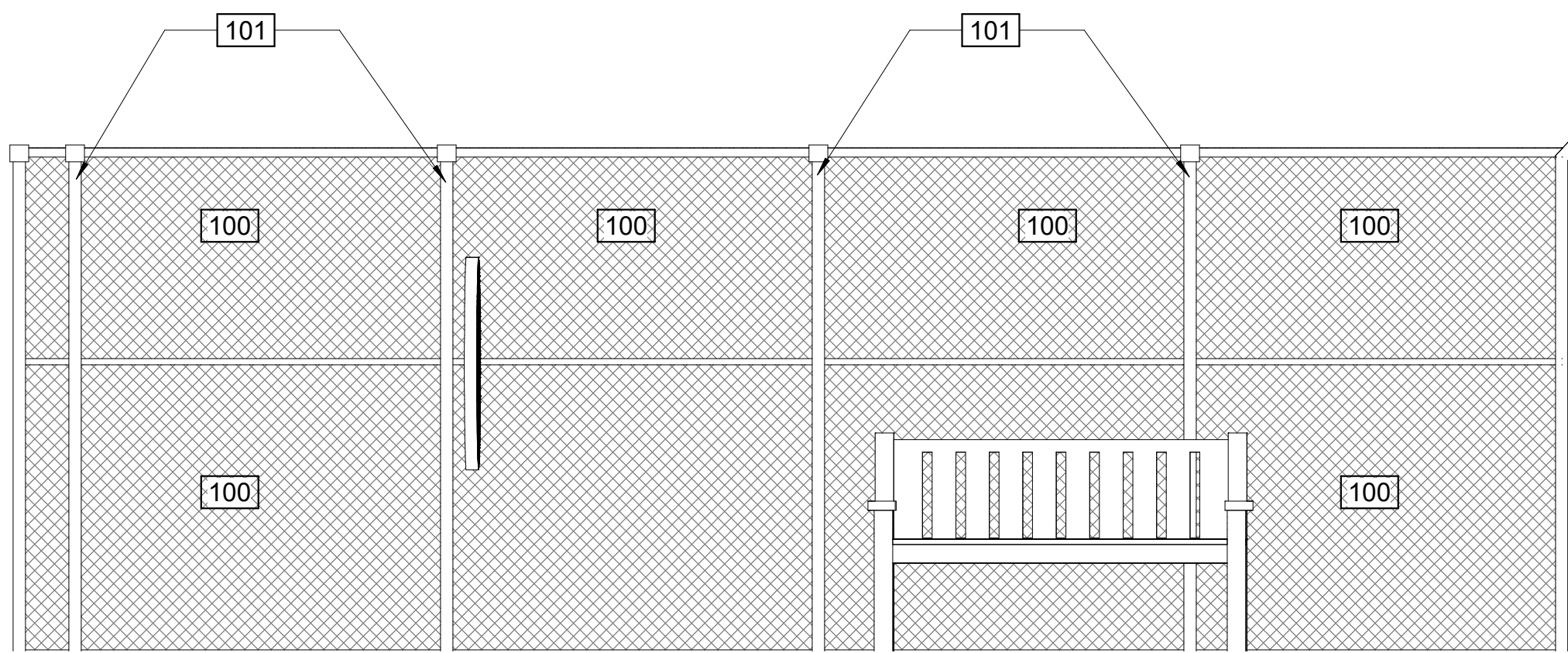

1 FENCING DETAIL
1/2" = 1'-0"

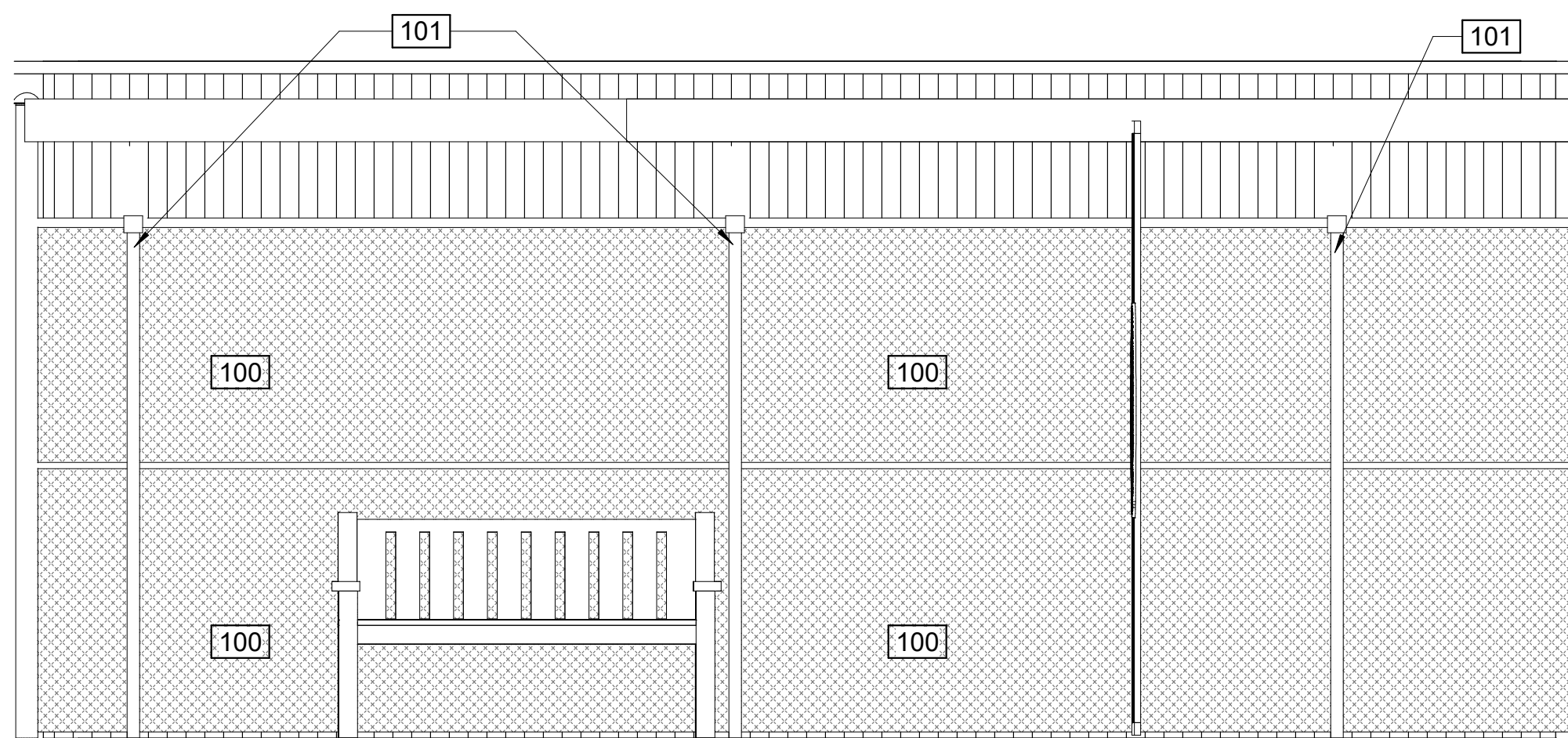

2 FENCING DETAIL
1/2" = 1'-0"

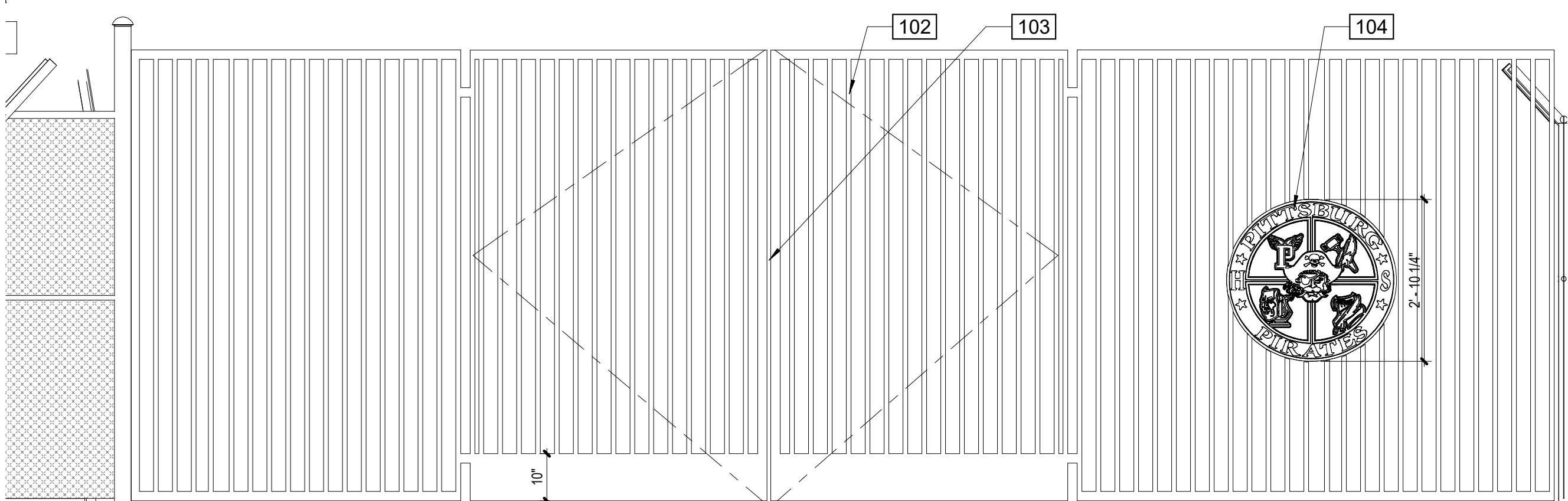

3 FENCING GATE DETAIL
1/2" = 1'-0"

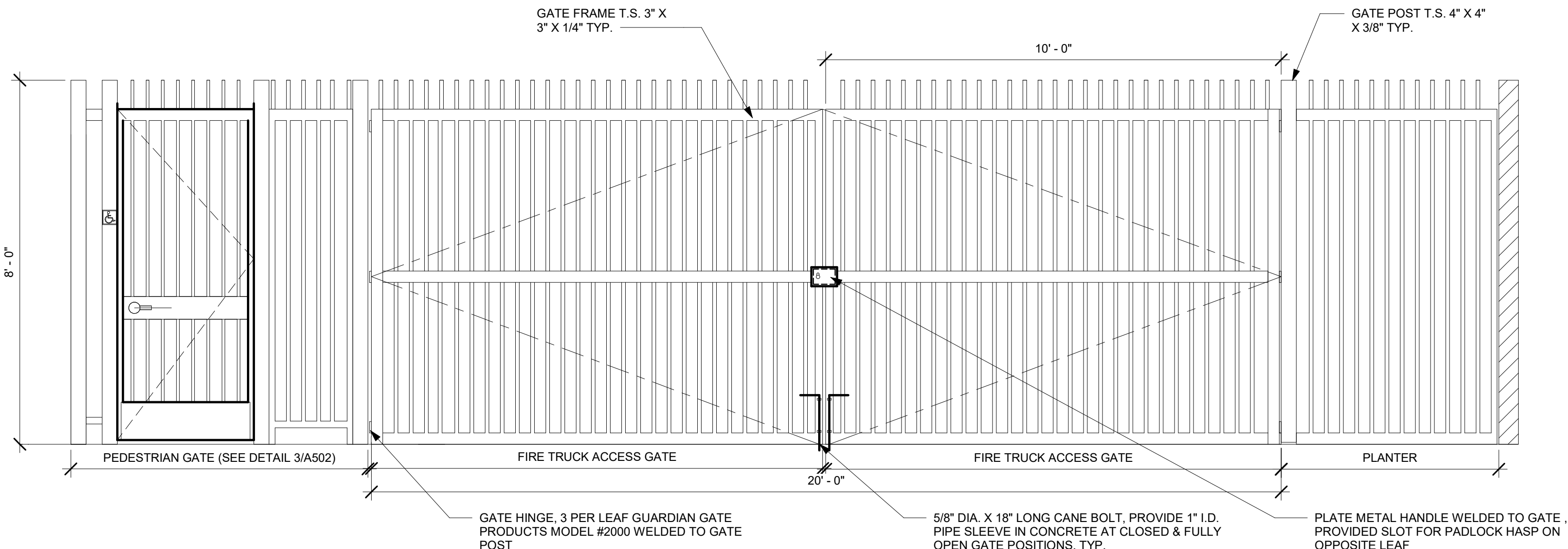

5 ENTRY GATE AND FENCE
1/2" = 1'-0"

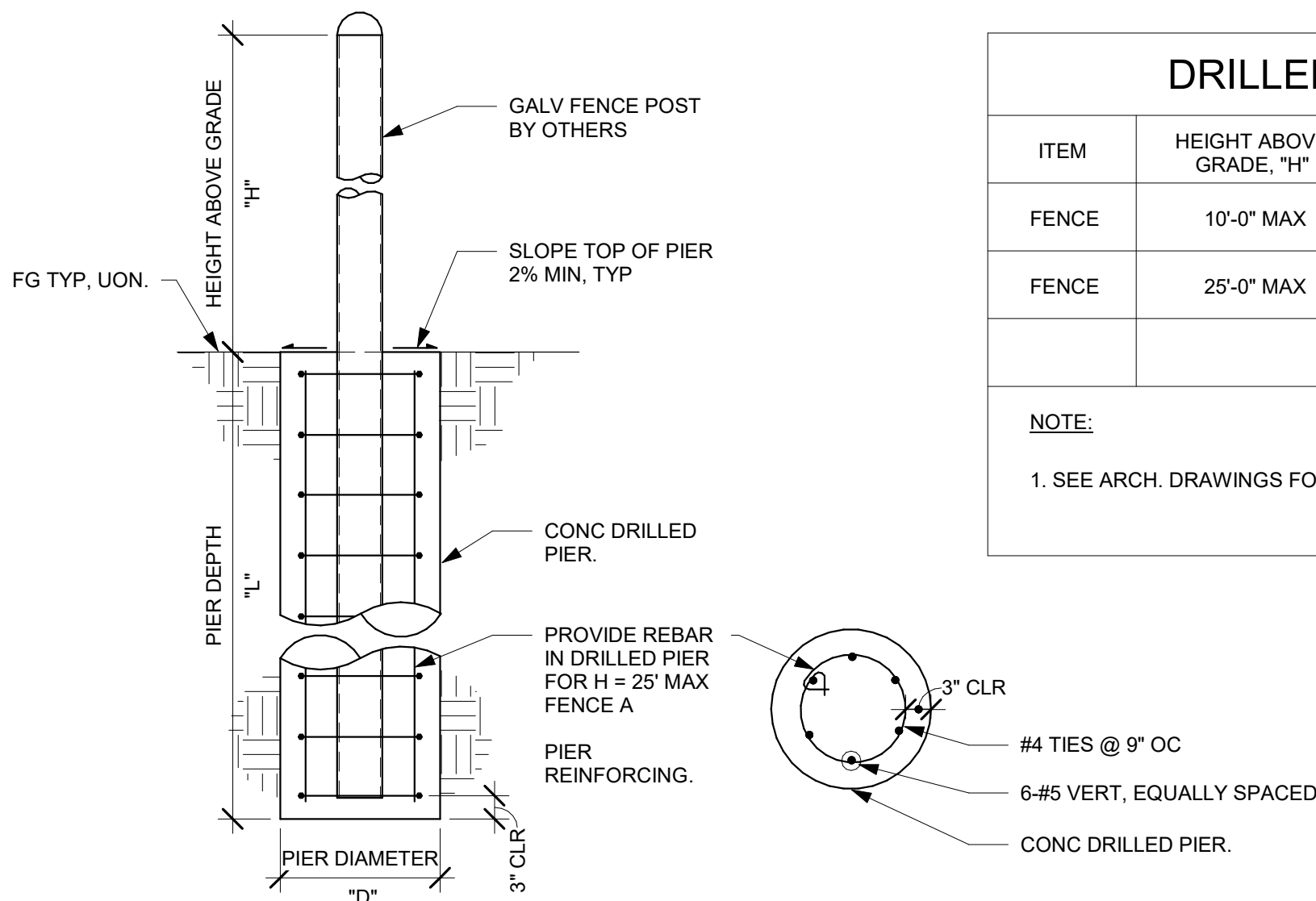

4 FENCE POST FOOTING DETAIL
1 1/2" = 1'-0"

DRILLED PIER SCHEDULE			
ITEM	HEIGHT ABOVE GRADE, "H"	PIER DIAMETER "D"	PIER LENGTH "L"
FENCE	10'-0" MAX	1'-6"	8'-0"
FENCE	25'-0" MAX	2'-0"	11'-0"
NOTE: 1. SEE ARCH. DRAWINGS FOR LOCATION OF FENCE.			

KEYNOTES

- 100 (N) PROPOSED VINYL COATED FENCE FABRIC
- 101 (E) POSTS TO BE CLEANED, PRIMED AND PAINTED BLACK
- 102 (N) TUBE STEEL GATE AND FENCING 3/4" X 3/4" TUBE STEEL PICKETS @ MAX 4" O.C. TOP AND BOTTOM RAIL 2" X 2"
- 103 SEE SHEET A502 FOR GATE HARDWARE
- 104 (N) SCHOOL LOGO SIGNAGE BY DISTRICT
- 105 SEE DETAIL 4/203 FOR FENCE POST FOOTING DETAIL



RODOLFO L. CHACON
EMAIL: rodolfo@chaconarchitecture.com
PHONE: 925-504-8098
ADDRESS: 2106 BOLERO,
BAY POINT, CA. 94565
WWW.CHACONARCHITECTURE.COM

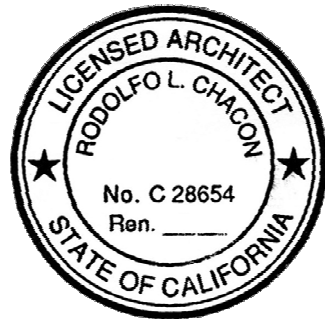

STADIUM PARKING
LOT
REPLACEMENT
PROJECT

1750 HARBOR STREET
PITTSBURG, CA



Pittsburg Unified School
District 2000 Railroad Ave.
Pittsburg, CA 94565

XX	01/07/2025	

PROJECT NO: PROJECT NUMBER
SUBMITTAL DATE:

SHEET TITLE

PROPOSED
FENCING GATE
ELEVATIONS

A203

